

## SHEPHERD UNIVERSITY WELLNESS CENTER

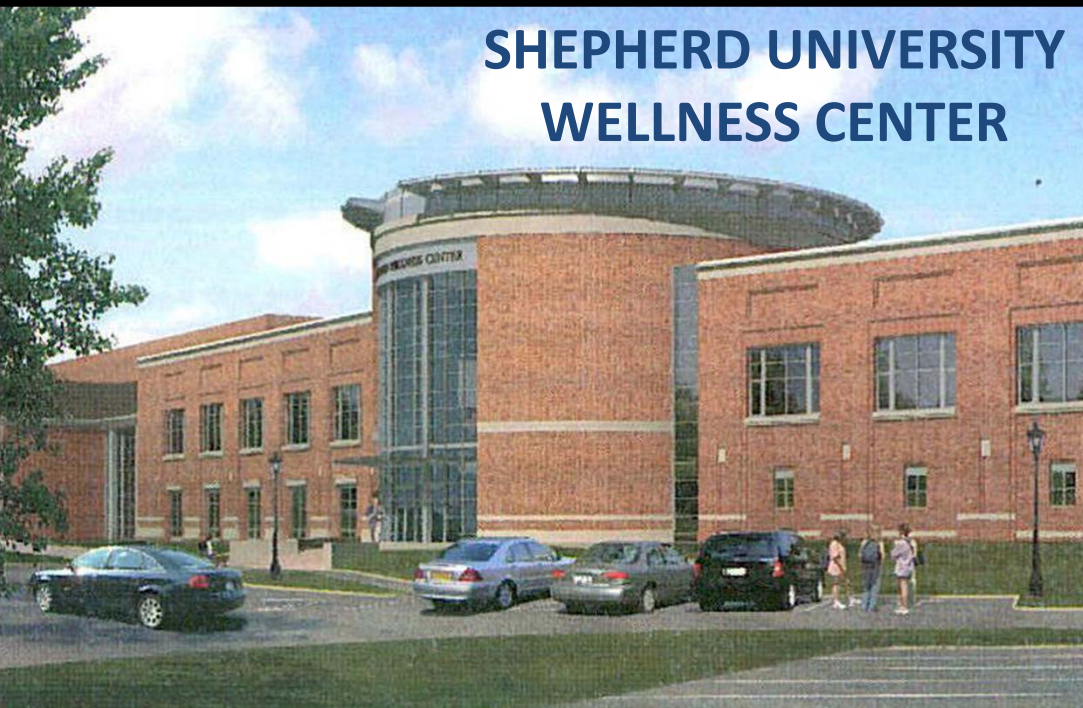

LOCATION SHEPHERDSTOWN, WEST VIRGINIA  
OCCUPANT FITNESS AND EDUCATION CENTER  
SIZE 73,400 SQUARE FEET  
LEVELS TWO

ARCHITECT HUGHES GROUP ARCHITECTS  
LIGHTING AND BRINJAC ENGINEERS  
MEP ENGINEER

## FITNESS ROOM

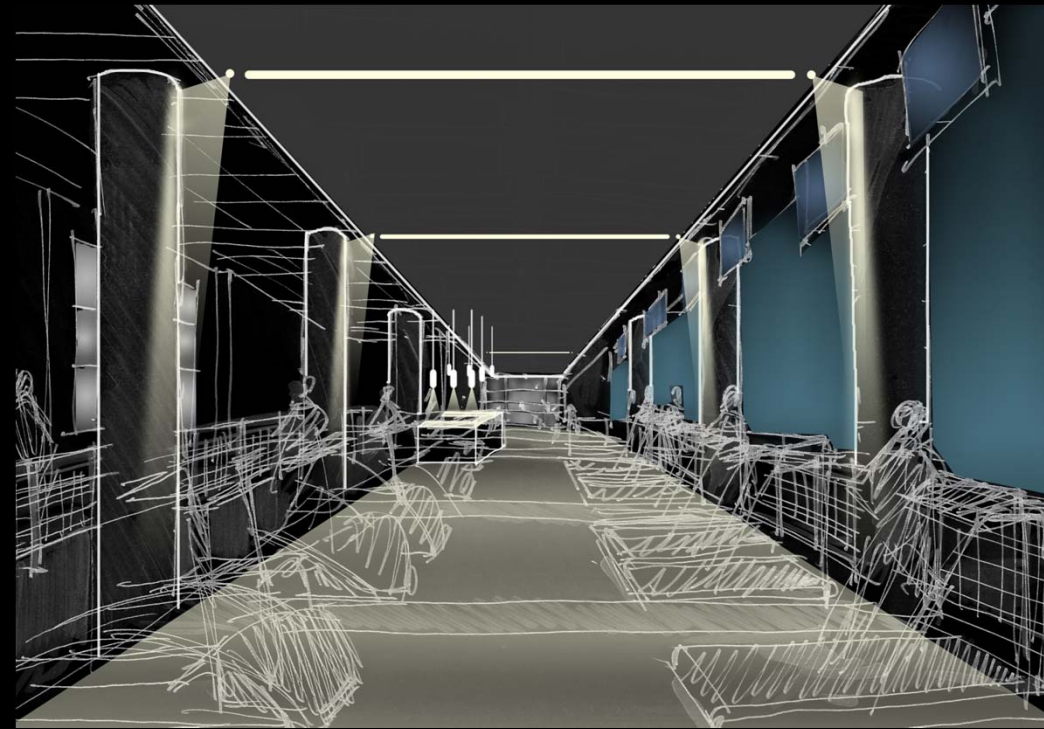
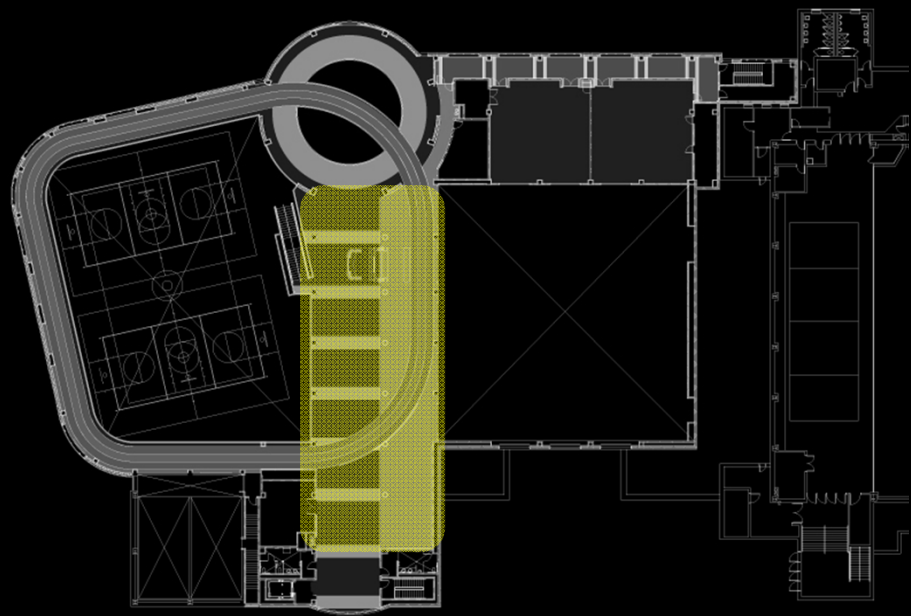

## DESIGN CRITERIA AND CONSIDERATIONS

- DIRECT AND REFLECTED GLARE
- UNIFORM LIGHT DISTRIBUTION ON TASK PLANE
- VISUAL CLARITY
- RECREATIONAL SPORTS ILLUMINATION OF 30 FC
- LIGHTING POWER DENSITY OF 0.9 WATTS/ SQ. FT.



## MULTI-PURPOSE ROOM

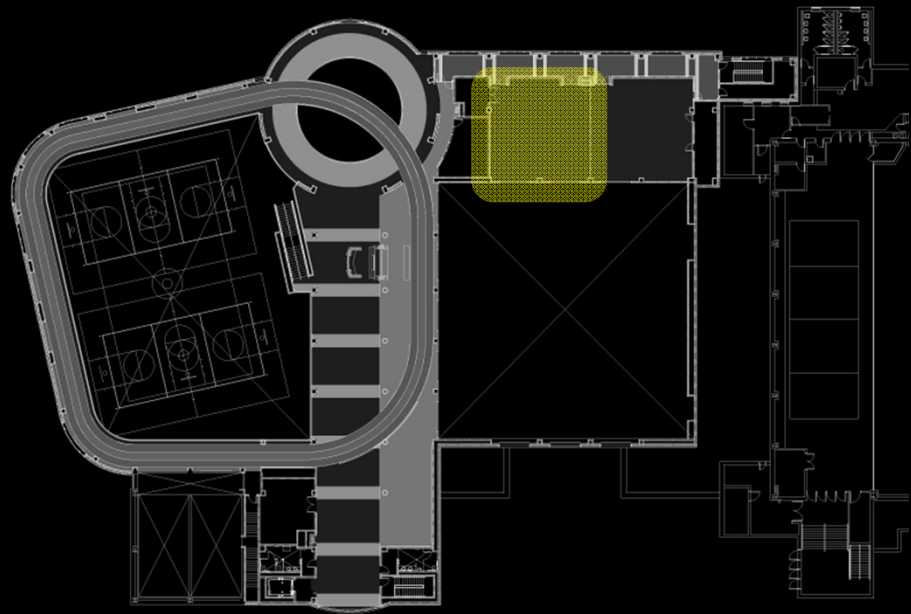

## ARCHITECTURAL BREADTH

- KEY GOALS FOR THE SPACE
- REASONS FOR RE-DESIGN OF INTERIOR ARCHITECTURE